

KIDA

FOOTSTOOL

Design by **Stephen Burks** | Ref. **CW5** | Weight **4,3 kg/2 lbs** | COM (Customer Own Material): **0,8 m/0.87 yds** (plain fabric only)

Measurements

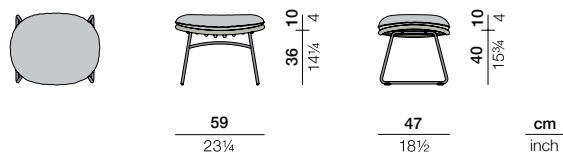

Collection: With KIDA, Stephen Burks has designed a collection as delightful to look at as to use. This collection to be wrapped rather than woven in DEDON special Fiber Touch, features a cradle-like organic form that's open, airy, light and inviting.

Characteristics: Fresh, friendly, transparent, iconic, archetypal, geometric.

Frame: The seat frame is made of aluminum, and the base is constructed from stainless steel.

Frame Maintenance: Clean with a soft cloth or brush, warm water and a gentle cleanser, if needed.

Cushion Maintenance: The covers can be removed, and washed at 30 °C / 86 °F.

Craftsmanship in numbers: Length 105 m / 115 yds | Weaving hours: 11

Material Combinations

Fiber / Frame

Combination 1 Combination 2 Combination 3



glow touch **170** /
lipari **304**

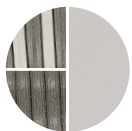

line touch **215** /
lipari **304**

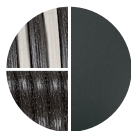

shade touch **206** /
black pepper **317**

Additional Items



Cover
CJN

Cushions

Dry+ seat cushion
CYL + fabric code

B 60 cm x T 47cm x H 10 cm
W 23 1/2" x D 18 1/2" x D 4"

Features



Contract

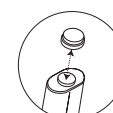

Interchangeable
glider



Cushion
holder

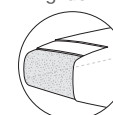

Dry+
cushion

To learn more about DEDON, our collections and warranty policy, please visit our website –

[dedon.de](https://www.dedon.de)

8/24

DEDON